

TRANSLINK INTERNATIONAL SALES LTD.

THE PIGPEN, MILL FARM, FARLOW, KIDDERMINSTER, WORCS. DY14 0LP ENGLAND

TEL : +44 1746 718740

FAX : +44 1746 718540

EMAIL : translink-international@dial.pipex.com WEBSITE : www.translink-international.com

STAINLESS STEEL HIGH
PRESSURE WASHGUNS



Product code **E315 – 0194** Wash Gun

A complete range of high quality and heavy duty stainless steel wash guns, complete with “dead man” low effort trigger control, flow straightener and standard interchangeable 1/4” nozzle.

Totally corrosion resistant for use in all conditions and temperatures.

Supplied with 1” quick release couplings – 1 x male fitted to wash gun and 1 x female supplied loose.

Robust design allows high level damage resistance during arduous tower climb operations.

Operating Pressure 1000psi; Maximum Pressure 3000psi

OPTIONS

1. Optional high quality stainless steel 63mm diameter pressure gauge suitable for an operational temperature range of – 25° C to + 98° C.
Black and red markings, glycerine liquid fill with brass movement.
(Code: C417-6059)
2. For use on coated and composite insulators reduced impact 7 / 32” nozzles are recommended (Code: C417-6058)
3. For high wind conditions, wash guns with 5/16” nozzles are available
(Code: C417-6056)
4. 3 / 4” quick release couplings (Code: E315-0194 -34)
5. 10 foot (3m) fly hose with quick release couplings 1” or 3 / 4” (Code: IW410049)



Product Code E315 - 0194 Wash Gun Details

QTY	PART NO	ITEM	MATERIAL	DESCRIPTION
ASSY	E315-0194	19	STN STL	WASH GUN COMPLETE ASSEMBLY
OPT	E315-0696		STN STL	PRESSURE GAUGE (OPTION) WITH TIP P315-0108
OPT	E315-0695	20	STN STL	NOZZLE ASSEMBLY 7/32"
OPT	E315-0694	20	STN STL	NOZZLE ASSEMBLY 5/16"
1	P315-0823	18	PLTD STL	QUICK RELEASE COUPLING MALE 1" BSP
1	P315-0199	17	STN STL	STEM (NOT SHOWN)
1	E315-0211	16	STN STL	HOUSING
1	P315-0464	15	STN STL	5/32 X 7/8 ROLL PIN
1	P315-0824	14	STN STL	TRIGGER
1	P315-0465	13	STN STL	3/16 X 7/16 DOWEL PIN (NOT SHOWN)
2	P315-0209	12	STN STL	YOKE BUSHING
2	P001-1252	11	PLTD STL	1/4 - 20 X 1/2 CAP SCREW
1	P315-0825	10	STN STL	YOKE
1	P315-0196	9	STN STL	INSERT
1	P315-0195	8	STN STL	SPRING
1	P315-0467	7	NYLON	O-RING (NOT SHOWN)
1	P315-0197	6	BRASS	BODY
1	P315-4681	5	NYLON	O-RING (NOT SHOWN)
1	E315-0200	4	NYL.BRS	DEFLECTOR DART (NOT SHOWN)
1	P315-0198	3	BRASS	ADAPTOR
1	P310-0108	2	STN STL	TIP EXTENSION
1	E315-0693	1	BRASS	NOZZLE ASSEMBLY 1/4"
QTY	PART NO	ITEM	MATERIAL	DESCRIPTION

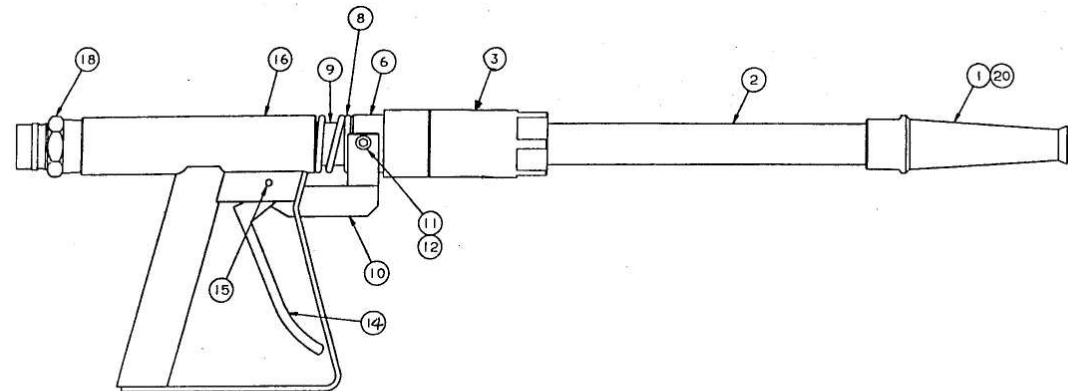

19 WASH GUN ASSEMBLY



**E315-0693
NOZZLE ASSY 1/4" 1**



**P310-0108
TIP EXTENSION 2**



**P315-0198
ADAPTOR 3**



**E315-0200
DEFLECTOR DART 4**



**P315-0197
BODY 6**



**P315-0195
SPRING 8**



**P315-0196
INSERT 9**



**P315-0825
YOKE 10**



**P315-0209
YOKE BUSHING 12**



**P315-0824
TRIGGER 14**



**E315-0211
HOUSING 16**



**P315-0199
STEM 17**



**P315-0823
QUICK COUPLER 18**



**E315-0194
WASHGUN 19**



**E315-0694 (OPTION)
NOZZLE ASSY 5/16"**



**P315-0108 (OPTION)
TIP PRESSURE GAUGE**



**E315-0696 (OPTION)
PRESSURE GAUGE**



**P315-OKIT
O RING KIT**



**P315-PIN KIT
PIN & SCREW KIT**

**WASH GUN SPARE
PARTS**

TRANS LINK





**IW410044 - 7 PIECE
WASH GUN TOOL REPAIR KIT**



**P315-0199
STEM**



**E315-0200
DEFLECTOR DART**



**TEE WRENCH FOR
DART STEM 7**



**DEFLECTOR DART
CLAMP 5**



CLAMP 5 IN ACTION



WRENCH 7 IN ACTION



**E315-0693
NOZZLE ASSY 1/4"**



**STEEL PUNCH FOR
1/4" JET 3**



**STEEL PUNCH FOR
5/16" JET 1**



**BRASS PUNCH JET
ASSEMBLY 2**



**WASHGUN BODY
SPANNER 4**



PUNCH 1 & 3 IN ACTION



**FLOW STRAIGHTENER
PUNCH 6**



PUNCH 6 IN ACTION



**E315-0194
WASHGUN**

**WASH GUN TOOL
KIT**

TRANS LINK

